



Amanda Howard Associates Ltd
21 Berwick Street
London W1F 0PZ
Tel: 020 7287 9277
Fax: 020 7287 7785
mail@amandahowardassociates.co.uk
www.amandahowardassociates.co.uk

JANE TOMBLIN

PRODUCTION DESIGNER

Titty Bang Bang-Series III, Pett Television. 7x30 min Episodes. Comedy sketch show

Titty Bang Bang-Series I, Pett Television. 7x30 min Episodes. Comedy sketch show

Bad Girls-Series VIII, Shed Productions. 10 x 60 min + 1 x 90min Episodes. Drama

Titty Bang Bang-Series I, Pett Productions. 6x30 min Episodes. Comedy sketch show

Bad Girls-Series VII, Shed Productions. 6 x 60 min + 6 x 90 min episodes. Drama

Bombshell-Series I, Shed Productions. 6 x 60 min + 1 x 90 episodes. Drama

The Heat of the Story, Ponder Films. 10 min short film, 35mm
(Selected for Palm Springs International Film Festival-Best Short Film)

Bad Girls-Series VI, Shed Productions. 12x 60 min + 2 x 90min episodes. Drama

Corgi Iguana, Jon Staton Productions. Commercial, 16mm.

Bad Girls-Series V, Shed Productions. 16 x 60 min episodes. Drama.

Bad Girls-Series IV, Shed Productions. 16 x 60 min episodes. Drama.

(Winner TV Quick Awards-Best Drama)

Bad Girls-Series III, Shed Productions. 16 x 60 min episodes. Drama.

(Winner-TV Quick Awards-Best Drama + National TV Awards-Best Drama)

Bad Girls-Series II, Shed Productions. 13 x 60 min episodes. Drama.

(Winner-TV Quick Awards-Best Drama + National TV Awards-Best Drama)

Data Protection Act, UIP/New World Productions 10 min Corporate, 16mm.

Vauxhall Zafira, Park Avenue Productions. Commercial, 16mm.

Generation Gap, Soho Communications. Commercial, 16mm.

James Blond, Soho Communications. 10 min Corporate, 16mm.

Bombs, The Moving Picture Company. 20 min Corporate, 16mm.

Southern Water Services, Moving Picture Co. 16min Corporate, 16mm

Citroen Saxo/Park Avenue Productions, Promotional Film, 16mm

Bad Girls-Series I, Shed Productions. 6 x 60 min episodes. Drama.

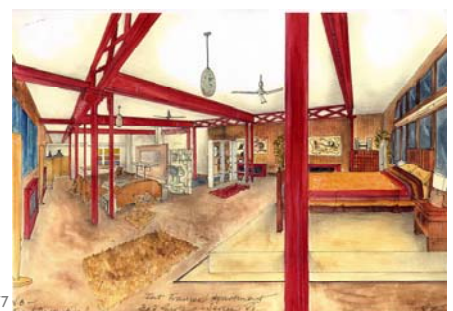

Supervising Art Director

Bad Girls-Series I, Shed Productions. Draught and Supervise Set Build. Drama.

Senior Art Director

Long Time Dead, Working Title, Feature Film. 35 mm.

Up Rising, Tiger Aspect. 6 x 50 min episodes, 16 mm. Drama

Wonderful You, Hartswood Films. 7 x 60 min episodes, 16 mm. Drama.

An Unsuitable Job for a Woman, United, Ecosse Films. 2 x 2hr episodes, 16 mm. Drama.

Heaven on Earth, Red Rooster Productions. 2 x 90 min episodes, 16 mm. Drama

Hospital, Red Rooster Productions, pilot for Channel 5. 60 min pilot for Channel 5, 16 mm. Comedy Drama

Family Money, Whistling Gypsy Productions. 4 x 60 min episodes, 16 mm. Drama

True Blue, Film & General, Feature Film based on fact. 35 mm. Drama

The Sculptress, Red Rooster Productions. 6 x 60 min episodes, 16 mm. Drama

Peak Practice III, Central Television. 6 x 60 min episodes, 16 mm. Drama

The Knock, Bronson Knight Production. 7 x 60 min episodes, 16 mm. Drama

Rides II, Warner Sisters. 8 x 60 min episodes, 16 mm. Drama

Secret Weapon, Picture Partnership. 6 x 60 min episodes, 16 mm. Drama

Traffik, Carnival Films. 6 x 60 min episodes, 16 mm. Drama (Winner BAFTA-Best Design)

Roger and the Rottentrolls, The Children's TV Company. 8 x 20 min episodes. Video

Commercials include: **Scoot / Stella Artois / Transco / Whiskas / National Savings / ITC Trailers / BBC Christmas**

Set Decorator

Minder VIII, Euston Films. 13 x 60 min episodes, 16 mm. Drama

Minder VII, Euston Films. 13 x 60 min episodes, 16 mm. Drama

Standby / Assistant Art Director

Double Zero, Alma Gate Productions. 90 min Feature Film, 35 mm. Spoof Drama

Havana, Havana Productions. 1950's Period Feature Film, 35 mm. Drama

Peak Practice II, Central Television. 13 x 60 min episodes, 16 mm. Drama



Peak Practice I, Central Television. 13 x 60 min episodes, 16 mm. Drama

Rides I, Warner Sisters. 8 x 60 min episodes, 16 mm. Drama

The Paradise Club, Series I & II. 10 x 60 min episodes, 16 mm. Drama

Draftsperson

Indiana Jones and the Last Crusade, Lucasfilm. 90 min Feature Film, 35mm. Drama

Who Framed Roger Rabbit?, Lucasfilm. 90 min Feature Film, 35mm. Drama / Animation

The Saint, The Saint Productions. 6 x 60 min episodes, 16mm. Drama

The Millenium, Framestore, Jeremy Isaacs. 40 min, 16 mm. Factual/ Historical/ Drama

Art Department Assistant

Haunted Honeymoon. 90 min Feature Film, 35 min. Drama

King David. 90 min Feature Film, 35 mm. Drama

Exhibition Design

Erotica II-Art Gallery Design

Erotica I-Art Gallery Design

Education

BBC TV Design Course at Chelsea School of Art

Foundation Course at St Albans College of Art & Design



Up to date information on Jane's work can be seen at www.amandahowardassociates.co.uk/jt